

KUT's Response to the Novel Coronavirus (COVID-19)

Jan. 15, 2021

To all Students, Faculty and Staff

President, Kochi University of Technology

<Major revision to the past notice>

- Requesting to refrain from having meals, parties and karaoke with friends until end of the fourth quarter (Item 2)
- Extended the the Suspension Period of Extracurricular Activities (Item 5)

KUT requests all the students, faculty and staff of KUT to follow the measurement described below.

Now, even healthy people who have no symptom may have coronavirus and may spread it. In order to avoid not only catching the virus but also spreading the virus, your cooperation to follow the instruction and to work together is appreciated.

1. Everyday preventive actions

Please keep taking the following basic preventive actions, such as keeping social distance with others, wearing a facemask and washing your hands frequently, and also try to practice “New Lifestyle” shown in the attachment in your daily life so that you can continuously take preventive measure against COVID-19.

- (1) Take enough sleep and well-balanced diet of nutrition to increase your immunity.
- (2) Wash your hands with soap and water frequently. Using alcohol-based hand sanitizer gel is also effective. The virus within droplets may stuck on the surface and others can be infected by touching their mouths, nose, or possibly, eyes, after touching the surface that has the virus on it. Possible channels of such transmission include hand straps of trains and buses, doorknobs, switches and buttons.
- (3) Dry air will cause a reduction of defense function of the mucous membrane of the throat. Try to keep a proper humidity (around 50%-60%). Humidifier is one of the most reliable appliances. It is also effective to wash your mouth frequently.
- (4) Please avoid places where there are many people as much as possible. In particular, please avoid dining or drinking together in large groups.
- (5) Please wear a mask when going out. In situations where it is not possible to maintain sufficient distance between yourself and others, please always wear a mask, especially indoors. However, wearing a mask in a high temperature or high humidity environment may increase the risk of heatstroke, so remove your mask when you are outdoors and able to maintain sufficient distance from others (at least 2 meters).
- (6) Please observe proper coughing etiquette. Always wear a mask when you have symptoms such as coughing or sneezing, and in the event you must cough or sneeze while not wearing a mask, please use a tissue, handkerchief, sleeve, or the inside of your elbow to cover your mouth and nose. If you stifle a cough or sneeze with your hands, the virus will be spread to anything you touch with your hands. If you accidentally used your hands, please wash them thoroughly, and use alcohol hand sanitizer if available.
- (7) Please ventilate room frequently. (Open windows to ventilate for few minutes, more than once per 30 minutes. Open more than 2 windows at different side of the room if the room has multiple windows so that

wind can flow. If the room has only one window, open the door.)

- (8) Try to avoid using goods and equipment, such as phones, PCs and desks, with multiple people. If you need to use them unavoidably with others, sanitize them frequently.
- (9) Check your health condition every morning (taking your temperature, etc.) and log it.

2. Precautions to prevent mass infection

Many new clusters are being reported at places where young people and students congregate, such as restaurants and parties. More and more cases of infections among university students are being reported. Each person must endeavor to change their behavior to adapt to the "new normal."

Additionally we strongly request to refrain from having meals and drinks and karaoke with friends until end of the fourth quarter so that we can complete the curriculum of this academic year.

- (1) Thoroughly avoid places where there is increased risk of the three Cs: closed spaces, crowds, and close contact settings.
- (2) Strictly refrain from parties and meals with large groups.
- (3) If using restaurants for group meals, ensure that the restaurant has taken preventive measures like installing protective panels to block the dispersion of droplets (in Tokyo and Osaka, some shops complying with industry guidelines post stickers to indicate this).
- (4) Refrain from loud behavior (such as talking loudly in restaurants, taking part in karaoke or other social events, cheering at sporting events, et cetera).
- (5) Refrain from large-scale group trips for clubs and events and training camp for extracurricular activities.
- (6) When engaging in part-time work, it is important to wear a mask at all times, and to select a workplace where sufficient preventive measures are in place.
- (7) Take adequate prevention measures before, during, and after club activities, including during practice. (Such as proper use of club rooms and changing rooms, selecting suitable restaurants, et cetera)
- (8) Endeavor to fully wear a mask, wash your hands and disinfect them, and ventilate the space on a regular basis.
- (9) Please consider using the "COVID-19 Contact Confirming App COCOA", recommended by the Ministry of Health, Labor and Welfare.

<https://www.mhlw.go.jp/content/10900000/000647649.pdf>

Reference

-Attached PDF "5 Scenarios that Raise the Risk of Infection" in English

3. In case of flu like symptoms

- (1) If you have any symptoms, such as a fever or cold-like symptom, stated on "3) He/she has no symptom of the following" of "6. Three conditions to join university-related activities", you must remain at home. Please avoid seeing people as much as possible.
- (2) If you have any symptoms, please refer to the attachment provided by Ministry of Health and Welfare (Japanese version only) for when to see a doctor. Also, please contact at IRC. If your body temperature exceeds 37.5 degrees Celsius, you must see a doctor promptly.
International Relations Section TEL : 0887-53-1130 Email : international@ml.kochi-tech.ac.jp
- (3) You must not visit a clinic/hospital without prior contact by phone. Also, refrain from visiting multiple clinics or hospitals.
- (4) Please contact IRC when you have taken a test for COVID-19 from an administrative organ such as PCR.
- (5) Even if you recovers, please stay home until no symptom appears. Please follow instructions from a doctor if you are ordered a period for recuperating at home. If you take a test for COVID-19 from an administrative organ such as PCR as per instructions from a doctor, please don't attend any university

activities and stay at home for 3 days from the day after no symptom appears, even the result is negative.

4. Regarding classes and research activities

(1) Classes and research activities in the fourth quarter

- Classes in the fourth quarter have been held in face-to-face as much as possible, with the exception of lectures with large numbers of attendees, with appropriate measures, such as restricting available seats in classes, etc. Please refer to the notification on December 3 “Commencement of Classes in Fourth Quarter”.
- Research activities have been conducted with careful countermeasures, such as preventing the three C's etc.

5. Extracurricular activities

(1) Extracurricular activities (group activities) will be prohibited for the following period at the beginning of the year. During this time, we will also cease the lending of university facilities for group activity use.

Duration: From Friday January 1 through Monday February 8, 2021

- (2) During periods outside of the above, extracurricular activities will be permitted if infection prevention measures are taken. The use of sports facilities will also be permitted, with some exceptions. However, please refrain from external activities like practice games and training camps, etc. (there will be exceptions, such as official games).
- (3) “8. Travel of Students” will apply to extracurricular activities (including one day trips).

6. Three conditions to join university-related activities (permitted university-related activities)

Students who have met all the three conditions are allowed to join face-to-face university-related activities (face-to-face classes, laboratory activities, extracurricular activities and other activities KUT permits). Those students who do not meet any one of the following conditions must stay at home:

(1) He/she is not applicable to all of the following.

- ① He/she is infected with the novel coronavirus
- ② He/she is certified as the person who had close contact with an infected person or the subject of administrative tests, including PCR test.
- ③ His/her family member or house mate has been certified as the person who had close contact with an infected person or the subject of administrative tests, including PCR test.
- ④ He/she has (or might have) had close contact with an infected (or suspected infected) person.
- ⑤ He/she has been requested by a medical facility or a public health center to stay at home.
- ⑥ He/she is ordered by KUT to stay at home.

(2) He/she is not applicable to all of the following.

- ① He/she entered Japan in the past 2 weeks from other countries
- ② He/she had close contact in the past 2 weeks with someone who had entered Japan within 2 weeks prior to the contact.

(3) He/she has no symptom of the following:

Fever over around 37.5°C, Cough, Sneeze, Runny nose, Nasal Congestion, Sore throat, Phlegm, Cold symptoms, Fatigue, Shortness of breath, Taste/Smell disorder

* Expect for the symptoms you are aware of the cause, such as fey fever

* For example, even if you only have a sore throat and are unsure if it is a different illness you are aware of, please remain at home.

* Regarding fevers, be sure to remain at home if your temperature exceeds 37.5 degrees Celsius. Even if your temperature is below 37.5 degrees, if your normal temperature is in the range of 36 degrees and

you feel like you have a fever, please remain at home just in case.

* If by some chance you have been infected with the novel coronavirus, you will need to remain at home to avoid infecting other people, so, if there is concern, please choose to remain at home.

- Students for whom item (1)* or (2) above applies or who have taken a test for COVID-19 from an administrative organ including a PCR test under doctor's advice must not join any university-related activities and must notify the contact desk below. If you are not sure this applies to you, please contact us and don't join any university-related activities as well. As for the time of resuming face-to-face university related activities, KUT will inform the individual after the consultation with Public Health Center and other related institutions. * Except (1)-⑥

International Relations Section

TEL: 0887-53-1130 E-mail: international@ml.kochi-tech.ac.jp

- In case the "COVID-19 Contact Confirming App COCOA", recommended by the Ministry of Health, Labor and Welfare, confirms that you have had close contact with a person who tested positive for COVID-19, please don't attend any university activities and make phone call to see a doctor. In case you take/have taken a test for COVID-19 from an administrative organ including a PCR test under doctor's advice, please contact International Relations Section.

- Students who would like to consult about the conditions above
Health Consultation Office

TEL: 0887-57-2020 (Weekday 8:30-17:15)

* If you are international student, please contact the following.

International Relations Section

TEL : 0887-53-1130 Email : international@ml.kochi-tech.ac.jp

7. Administrative Services at the Administrative Office

Students need to contact the section in charge via email or phone in advance if he/she wishes to come to the administrative office. The person in charge will inform him/her the date and time he/she can come to the office. This applies to their visiting to the Health Consultation Office. Please refer to the email as of May 19th.

8. Travel of Students

(1) We set outbreak areas as follows, and ask students to avoid travel to these areas.

- Travel subject to restrictions: All travel, including personal travel, job hunting, extracurricular activities, research, academic conference participation, etc. (includes day trips)
- If you must travel to an outbreak area (excluding Kochi Prefecture) due to unavoidable circumstances, stay at home and monitor your health for a period of 14 days, with the day following your return to Kochi Prefecture counted as the first day. Students are required to submit an absence notice and according to the instructions of the lecturer complete assignments or take recorded ondemand classes

【Outbreak areas】

Prefectures where the number newly infected per 100,000 people is 15 or greater

*Each Friday, the outbreak areas have been updating on the university website (under "Response to the Coronavirus (COVID-19)"), with restrictions applying to trips to that area for a period of 7 days from the following Monday (from Monday to Sunday).

*The definition of outbreak area is subject to change.

(2) If according to the above criteria, Kochi Prefecture is considered an outbreak area (currently as of 1/5, it is considered an outbreak area), we ask that you refrain from travel to locations outside of Kochi Prefecture.

Furthermore, if you must travel to an outbreak area (excluding Kochi Prefecture) for reasons out of your control, you must self-quarantine at home for 14 days.

- (3) When traveling, make sure you fully understand that the main routes of transmission of the coronavirus are through droplets and direct contact. Make every effort to prevent infection by wearing a mask, bringing and using portable hand sanitizer, staying away from crowded spaces, and select a means of transportation with a low risk of infection. Try to avoid stopping in areas other than your destination.

9. Job Hunting/Internships

Please refrain from travel for job hunting purposes if the destination is an outbreak area as described in “8. Travel of Students” (unless it is within Kochi). If Kochi is an outbreak area at that time, please refrain from travel to all areas outside of Kochi. If you must do activities related to job hunting or internships in an outbreak area (excluding Kochi) due to unavoidable circumstances, please quarantine for 14 days after your return.

Please consider asking companies to change to online interviews, etc. with the help of the faculty members in charge of employment guidance in your academic group/course.

We prepared individual rooms with an environment to join an online seminar or online interview or so at both campuses. Please contact International Relations Section in advance if you would like to use.

10. Attendance or business trips of the faculty members and staff

- (1) As for physical attendance, judge yourself according to the KUT measure stated in the item 6 “Three conditions to join university-related activities”. If you do not meet the criteria, please report to your department head and the Personnel Section (contact information at the end of this document), and work from home. Alternatively, you may take special vacation time according to the instruction given by the Personnel Section. In the event that you are required to undergo an administrative inspection, such as a PCR test, please contact your department head and the Personnel Section.
- (2) Business trip for professors will be decided upon by the professors themselves, and trips for administrative staff will be decided upon by the department head. However travel to areas that correspond with outbreak area as described in “8. Travel of Students” is prohibited (unless it is within Kochi). If the travel is deemed absolutely necessary by the department head and the Personnel Section, you will be allowed to go on the condition that you quarantine and work from home for 14 days after your return. If Kochi is an outbreak area at the time of travel, all travel outside of the prefecture will be prohibited.
- (3) Invitation from outside of Kochi and private travel will be handled following (2).
- (4) In-person events within 2020 are subject to the following measures. However, these measures may be subject to change depending on emergent conditions regarding COVID-19.
 - Hosting of events at which unspecified numbers of extramural congregate is forbidden, irrespective of whether within or without the campus.
 - A decision on whether to host a small-scale event at which exact participants can be identified should be made following consultation with the relevant parties (please consult the General Affairs Section; address is found at the end of this document.)

11. Visiting to/from overseas countries

- (1) The university prohibits all students, faculty and staff from going abroad and from inviting someone from other countries.
- (2) If you go abroad or invite someone from other countries due to unavoidable circumstances, you must notify the International Relations Section in advance. Due to strict quarantine, you may be requested

after entry into Japan to stay in the designated place for 14 days and not to use public transportation like trains, buses, taxis or domestic airlines.

12. If you entered Japan or had close contact with someone who had entered Japan in the past two weeks

- (1) You are not allowed to join any university-related activities in 2 weeks after entering Japan from other countries or after contacting with a person who had entered Japan in the past 2 weeks. Please stay at home for 2 weeks even if you do not have any symptoms. When you need to go out or see someone due to unavoidable circumstances, you must wear a face mask.
- (2) If symptoms, such as fever and cold, appears within 2 weeks after entering or contacting, please avoid contact with others, wear a face mask and report to the Counseling Center for Coronavirus Disease

【Contact】

*If you have symptoms such as shortness of breath, strong fatigue, cold symptoms or a high fever, or you suspect that you have been infected, please contact the following:

The Counseling Center for Coronavirus Disease

https://www.mhlw.go.jp/stf/seisakunitsuite/bunya/kenkou_iryuu/covid19-kikokusyasessyokusya.html

The Counseling Center for Coronavirus Disease, Kochi

TEL: 088-823-9300 Open hours: 9:00-21:00 everyday

<https://www.pref.kochi.lg.jp/soshiki/130401/2020020300117.html>

*If a faculty or staff member fail to meet “Three conditions to join university-related activities” or have taken an administrative test including a PCR test

Personnel Section

TEL: 0887-53-1112 Email: personnel@ml.kochi-tech.ac.jp

*If a faculty or staff member would like to consult about in-person events

General Affairs Section

TEL: 0887-53-1113 Email: general@ml.kochi-tech.ac.jp

*If you are planning to visit/invite someone to/from overseas countries due to unavoidable circumstances

International Relations Section

TEL : 0887-53-1130 Email : international@ml.kochi-tech.ac.jp

Contact at KUT

https://www.kochi-tech.ac.jp/about/contact/contact_info.html

【Related website】

Ministry of Health, Labor and Welfare

https://www.mhlw.go.jp/stf/seisakunitsuite/bunya/newpage_00032.html

"Overseas Travel Safety Information" web site provided by the Ministry of Foreign Affairs of Japan

<https://www.anzen.mofa.go.jp/>

"Overseas Travel Registration" service provided by the Ministry of Foreign Affairs of Japan

<https://www.ezairyu.mofa.go.jp/>

Example of practicing "New Lifestyle"

(1) Basic infection prevention measures for each person

Three basics for preventing infection:

① Keeping physical distance, ② wearing a mask, ③ washing hands

- ☐ Keep a distance of two meters as much as possible, or at least one meter, between two persons
- ☐ Chose outside rather than inside if you are to play
- ☐ Avoid standing right in front of each other during conversation as much as possible
- ☐ Wear a mask when you go out or talk inside even without any symptoms
- ☐ Wash your hands and face first when you get back home, followed by changing clothes and showering as soon as possible
- ☐ Carefully wash your hands with water and a soap for approximately 30 seconds (also possibly with hand sanitizer)
- ※ Pay more attention to your health, especially when meeting those who may have a high risk of serious symptoms, such as the elderly or people with chronic diseases.

Infection prevention related to traveling

- ☐ Refrain from traveling to and from where the infection is prevailing
- ☐ Refrain from traveling upcountry or for leisure. Business trips only when it is unavoidable
- ☐ Keep a record of the people you meet and the time of meeting in case you get infected
- ☐ Carefully follow how the infection is prevailing locally

(2) Basic lifestyle for daily life

- ☐ Wash and sanitize hands frequently
- ☐ Make sure to observe coughing etiquette (by covering your mouth)
- ☐ Ventilate frequently
- ☐ Keep physical distance
- ☐ **Avoid gatherings in crowded places, close contact settings and closed spaces**
- ☐ Check your health condition and measure body temperature every morning
- Do not force yourself to go out, and stay home if you have symptoms of fever or cold



(3) Lifestyle for each scene of daily life

Shopping

- ☐ Use online shopping
- ☐ Shop by yourself or in a small group, at off-peak hours
- ☐ Use electronic payment
- ☐ Plan your shopping in advance and shop quickly
- ☐ Refrain from touching displays like samples
- ☐ Keep a distance while lining up at the cashier

Leisure, Sports etc.

- ☐ Select places like parks at off-peak time
- ☐ Refer to videos for home muscle training or yoga
- ☐ Jog in a small group
- ☐ Keep a distance as etiquette when passing others
- ☐ Utilize booking systems for leisure
- ☐ Do not stay long in small rooms
- ☐ Keep a distance or stay online for singing or cheering others

Public Transports

- ☐ Refrain from chatting
- ☐ Avoid peak-hours
- ☐ Also take a walk or use bikes

Meals

- ☐ Take away or delivery
- ☐ Enjoy meals at outside spaces
- ☐ Serve individually, avoid sharing plates
- ☐ Do not sit face-to-face, rather besides
- ☐ Concentrate on eating, refrain from chatting
- ☐ Avoid serving alcohol, sharing glasses or sake cups

Family ceremonial occasions

- ☐ Avoid banquets or meetings with large numbers
- ☐ Decline participation when you have symptoms of fever or cold

(4) New working style

- ☐ Work remotely and rotate commuting shifts
- ☐ Keeping a distance while commuting during different working hours
- ☐ Open and widen working spaces
- ☐ Use online meetings
- ☐ Exchange business cards online
- ☐ Wear a mask and ventilate venues in case of a face-to-face meeting

※ Infection prevention guidelines for each business sectors will be prepared by relevant organizations.

新型コロナウイルス感染症についての相談・受診の目安

1. 相談・受診の前に心がけていただきたいこと

- 発熱等の風邪症状が見られるときは、学校や会社を休み外出を控える。
- 発熱等の風邪症状が見られたら、毎日、体温を測定して記録しておく。
- 基礎疾患（持病）をお持ちの方で症状に変化がある方、新型コロナウイルス感染症以外の病気が心配な方は、まずは、かかりつけ医等に電話で御相談ください。

2. 帰国者・接触者相談センター等に御相談いただく目安

- 少なくとも以下のいずれかに該当する場合には、すぐに御相談ください。（これらに該当しない場合の相談も可能です。）

☆ 息苦しさ（呼吸困難）、強いだるさ（倦怠感）、高熱等の強い症状のいずれかがある場合

☆ 重症化しやすい方（※）で、発熱や咳などの比較的軽い風邪の症状がある場合
（※）高齢者、糖尿病、心不全、呼吸器疾患（COPD 等）等の基礎疾患がある方や透析を受けている方、免疫抑制剤や抗がん剤等を用いている方

☆ 上記以外の方で発熱や咳など比較的軽い風邪の症状が続く場合

（症状が4日以上続く場合は必ずご相談ください。症状には個人差がありますので、強い症状と思う場合にはすぐに相談してください。解熱剤などを飲み続けなければならない方も同様です。）

- 相談は、帰国者・接触者相談センター（地域により名称が異なることがあります。）の他、地域によっては、医師会や診療所等で相談を受け付けている場合もあるので、ご活用ください。

（妊婦の方へ）

妊婦の方については、念のため、重症化しやすい方と同様に、早めに帰国者・接触者相談センター等に御相談ください。

（お子様をお持ちの方へ）

小児については、小児科医による診察が望ましく、帰国者・接触者相談センターやかかりつけ小児医療機関に電話などで御相談ください。

※なお、この目安は、国民のみなさまが、相談・受診する目安です。これまで通り、検査については医師が個別に判断します。

3. 医療機関にかかる時のお願い

- 複数の医療機関を受診することにより感染を拡大した例がありますので、複数の医療機関を受診することはお控えください。
- 医療機関を受診する際にはマスクを着用するほか、手洗いや咳エチケット（咳やくしゃみをする際に、マスクやティッシュ、ハンカチ、袖・肘の内側などを使って、口や鼻をおさえる）の徹底をお願いします。



Please cooperate in measures against infectious diseases.

The basic measures against infectious disease, as well as the novel coronavirus, are **washing hands** and **“coughing manners”** including wearing a mask.

1. Washing hands

Correct way to wash hands.

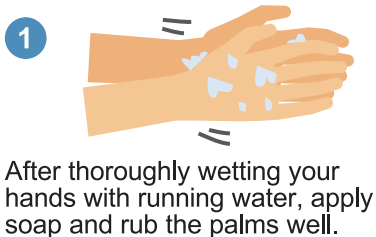

1 After thoroughly wetting your hands with running water, apply soap and rub the palms well.



2 Rub the back of your hands up and down.



3 Thoroughly rub the fingertips and nails.



4 Wash between your fingers.



5 Twist and wash your thumbs with the palms of your hands.



6 Don't forget to clean your wrists.

After cleaning with soap thoroughly rinse with water and wipe dry with a clean towel or paper towel.

2. “Coughing manners”

Three “coughing manners”



Coughing or sneezing without shielding your mouth or nose.

Using your hands to cover coughs or sneezing.



Wear a mask. (covering mouth and nose)

Cover your mouth or nose with a tissue/handkerchief.

Cough or sneeze into your sleeve.

Correct way to wear a mask.



1 Ensure both your nose and mouth are covered.



2 Place the rubber string over your ears.



3 Cover up to your nose so there are no gaps.



首相官邸
Prime Minister's Office of Japan



厚生労働省
Ministry of Health, Labour and Welfare



Ministry of Health, Labour and Welfare

Search

感染リスクが高まる「5つの場面」

場面① 飲酒を伴う懇親会等

- 飲酒の影響で注意力が低下する。また、聴覚が鈍磨し、大きな声になりやすい。
- 特に敷居などで区切られている狭い空間に、長時間、大人数が滞在すると、感染リスクが高まる。
- また、回し飲みや箸などの共用は感染のリスクを高める。



場面② 大人数や長時間におよぶ飲食

- 長時間におよぶ飲食、例えば深夜のはしご酒では、昼間の通常の食事に比べて、感染リスクが高まる。
- また大人数、例えば5人以上の飲食では、大声になり飛沫が飛びやすくなるため、感染リスクが高まる。



場面③ マスクなしでの会話

- マスクなしに近距離で会話することで、飛沫感染やマイクロ飛沫感染での感染リスクが高まる。
- マスクなしでの感染例としては、昼カラオケや野外のバーベキューでの事例が確認されている。



場面④ 狭い空間での共同生活

- 狭い空間での共同生活は、長時間にわたり閉鎖空間が共有されるため、感染リスクが高まる。
- 寮の部屋やトイレなどの共用施設での事例が確認されている。



場面⑤ 居場所の切り替わり

- 仕事での休憩時間に入った時など、居場所が切り替わると、気の緩みや環境の変化により、感染リスクが高まることもある。
- 休憩室、喫煙所、更衣室での事例が確認されている。車やバスで移動する際の車中でも注意が必要。



5 Scenarios that Raise the Risk of Infection

Scenario1 Social Gathering with Alcohol Involved

- Attentiveness and hearing are lowered when drinking alcohol, raising the tendency to speak loudly.
- The risk of infection particularly increases when staying with large groups in isolated spaces for extended periods.
- Sharing drinks and chopsticks also increase the risk of infection.

Scenario2 Dining with a Crowd or for a Long Time

- Dining for a long-time (such as barhopping) increases the risk of infection compared to normal daytime meals.
- Dining with large groups (5+ people) also raises the tendency to speak loudly, making it easier for droplets to fly and increasing the risk of infection.

Scenario3 Conversing without Masks

- Conversing at close distances increases the risk of infection via droplets or microdroplets.
- Infection due to not wearing masks has been confirmed in daytime karaoke gathering and outdoor barbecue parties.

Scenario4 Cohabitation in Tight Spaces

- Living together in tight spaces increases the risk of infection due to close distances being maintained for an extended period.
- Infection has been confirmed in shared facilities, such as dormitory rooms and toilets.

Scenario5 When you move

- Moving from a place to place (such as when taking a break from work) may lead to an increased risk of infection due to a change of environment or easing of tension.
- Cases have been confirmed in lounges, smoking areas, and lockers rooms. Please exercise care even while traveling via bus or car.